

BACKPACK WALL MOUNT

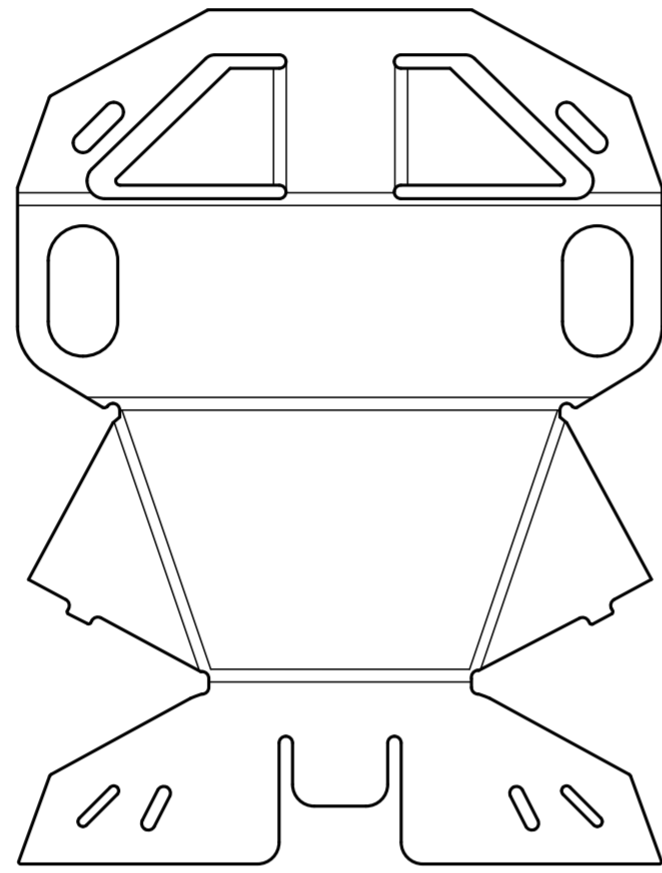

PART OVERVIEW

WHAT'S IN THE BOX

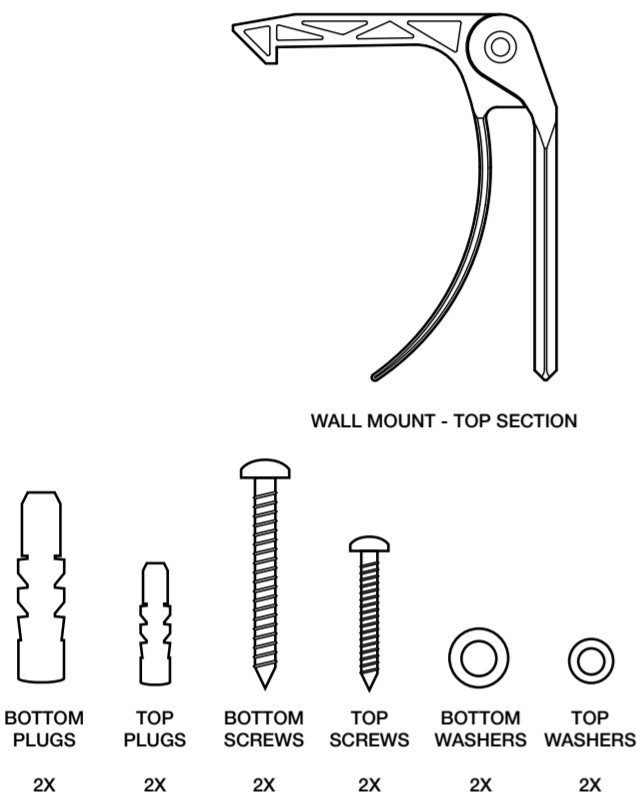

WALL MOUNT - BOTTOM SECTION

GETTING STARTED

TOOLS NEEDED

WHAT DO YOU NEED TO ASSEMBLE AND PLACE YOUR WALL MOUNT

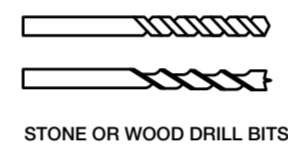

STONE OR WOOD DRILL BITS

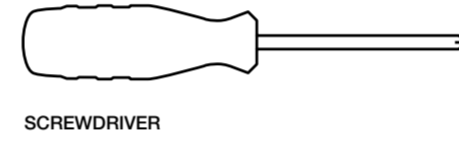

SCREWDRIVER

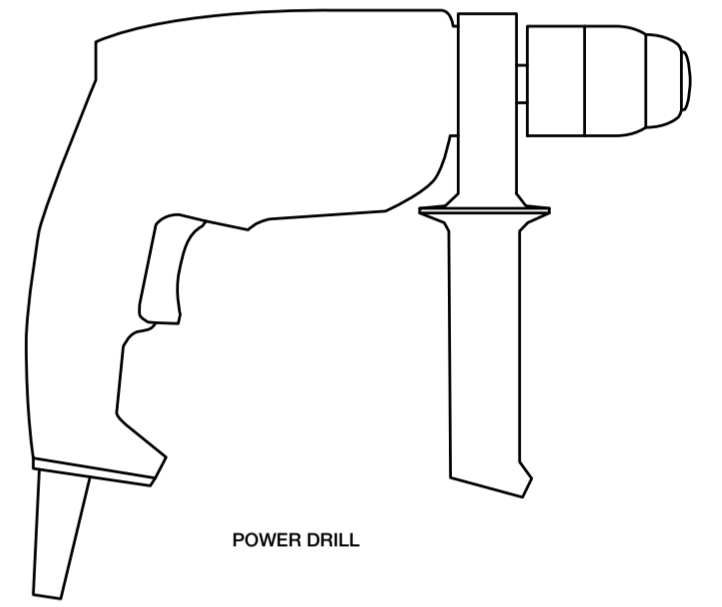

POWER DRILL

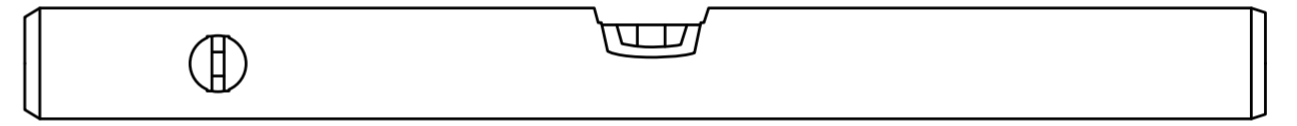

SPIRIT LEVEL

GETTING STARTED

FOLDING THE BOTTOM SECTION

FOLLOW THE STEPS BELOW TO ASSEMBLE THE BOTTOM SECTION

BE CAREFUL!
THE BLACK LINES SHOULD BE FACING UPWARDS!
YOU CAN ONLY FOLD EACH LINE ONCE OR IT MAY BREAK

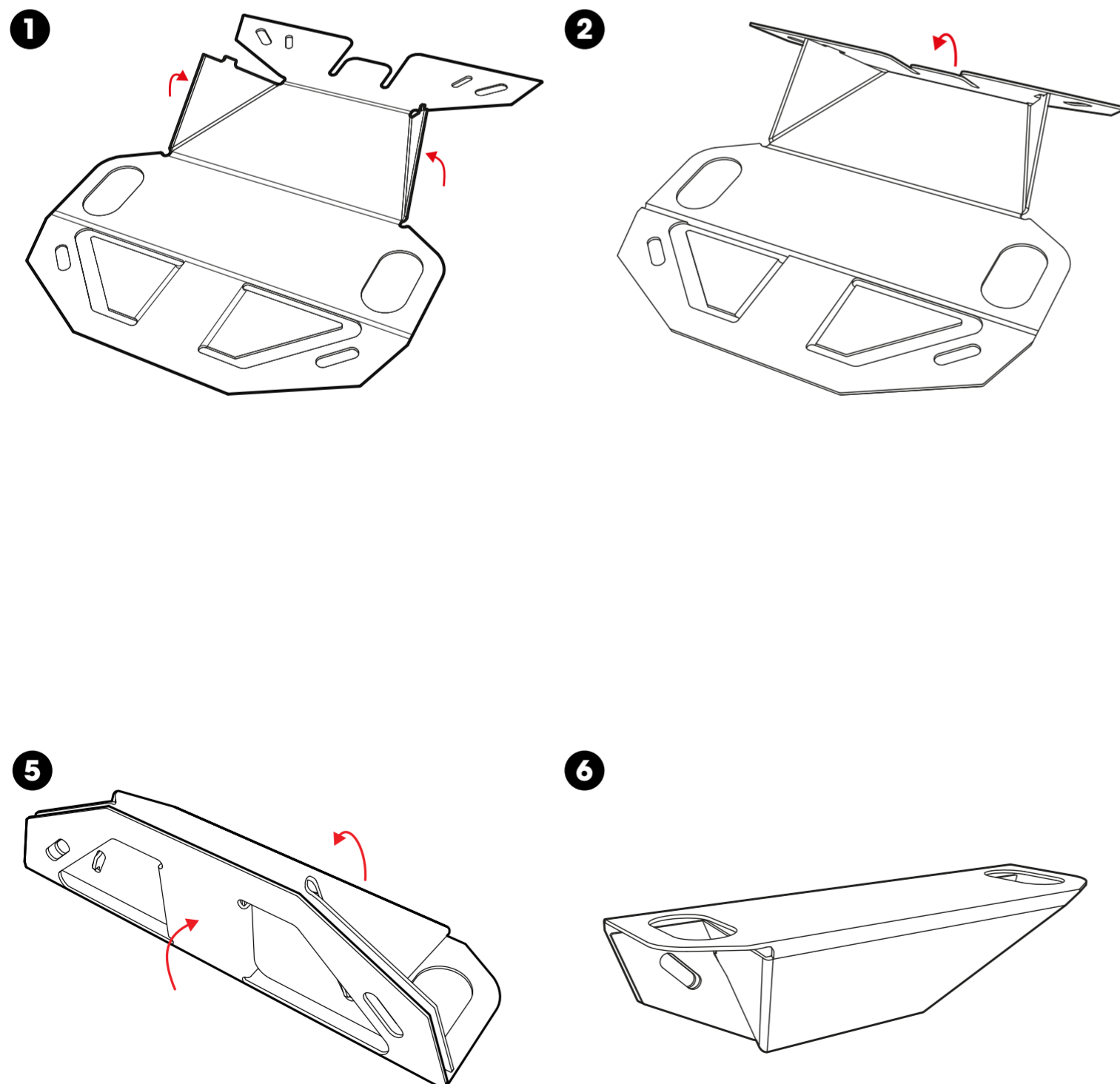

ASSEMBLY

SAFETY

SOLID GRAY Wall Mount ("SG-Mount" for short), is only to be used as a mount to hold a SOLID GRAY backpack on a flat vertical wall or surface. It is not meant to be used for any other purpose. SG-Mount is not safe to be used by children under 12 years old. Do not let children under 12 unattended with your SG-Mount. SG-Mount's manufacturers are in no way responsible for damage to material possessions nor personal harm caused by SG-Mount in any way. SG-Mount allows you to mount your backpack upright both empty or full, though it is your responsibility to make sure it does not fall as a result of improper placement, uneven distribution of weight or any other causes. SG-Mount's manufacturers and designers are in no way responsible for any damage to your backpack, any items stored inside the backpack, any surfaces SG-Mount is attached to nor for any damage caused by drilling or attaching SG-Mount to your wall. Do not expose SG-Mount to heat or open fire or to extended periods of sub-zero temperatures.

ASSEMBLY

Read this manual carefully before assembling and attaching your SG-Mount to the wall. Take special care, as the bottom section can be folded only once before the material may break. Keep the side with the black folding lines facing upwards, and only fold upwards. Take special care when drilling holes to attach your SG-Mount to the wall. Select the right different drill sizes, based on the material of your wall. Take care not to damage your wall, and check whether there are power mains, water mains, gas mains or other obstructions in the wall before drilling. SG-Mount comes with special plugs that allow it to be attached to surfaces like masonry and concrete, but also to hollow surfaces like dry wall. It is your responsibility to judge whether the material of your wall is sufficiently strong to hold SG-Mount and your backpack.

USAGE

Be careful not to overload your backpack while mounted, especially when SG-Mount is attached to a dry wall surface. When mounting your backpack, fit the feet of your backpack into the holes that are in SG-Mount's bottom section. Carefully position your backpack on SG-Mount's bottom section and gently push it backwards until SG-Mount's top section grabs your backpack's handle, and you are confident the backpack is mounted firmly.

MAINTENANCE

Do not leave SG-Mount exposed to sunlight for prolonged periods of time. Do not expose SG-Mount to moisture and/or humidity for prolonged periods of time. Keep your SG-Mount clean using a mild detergent and non-abrasive pad or cloth.

SPECIFICATIONS

Top material: PETG
Bottom material: Aluminium Polymer Composite
Sticker material: PVC

CONTACT

SOLID GRAY.

whatsapp/phone: +31 (0) 615204589
info@solid-gray.com
www.solid-gray.com
facebook.com/solidgray
instagram.com/solid_gray

MARKING THE DRILLING POSITIONS

POSITION THIS POSTER USING A SPIRIT LEVEL, AND HOLD IN PLACE WITH TAPE
USE THE RED GUIDES FOR A POLYMER PLASTIC BACKPACK
USE THE BLUE GUIDES FOR AN ALUMINIUM BACKPACK

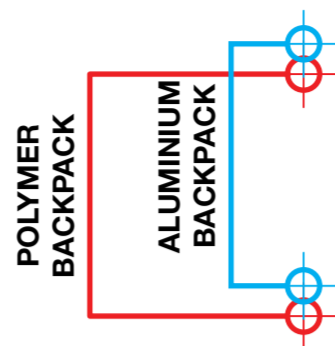
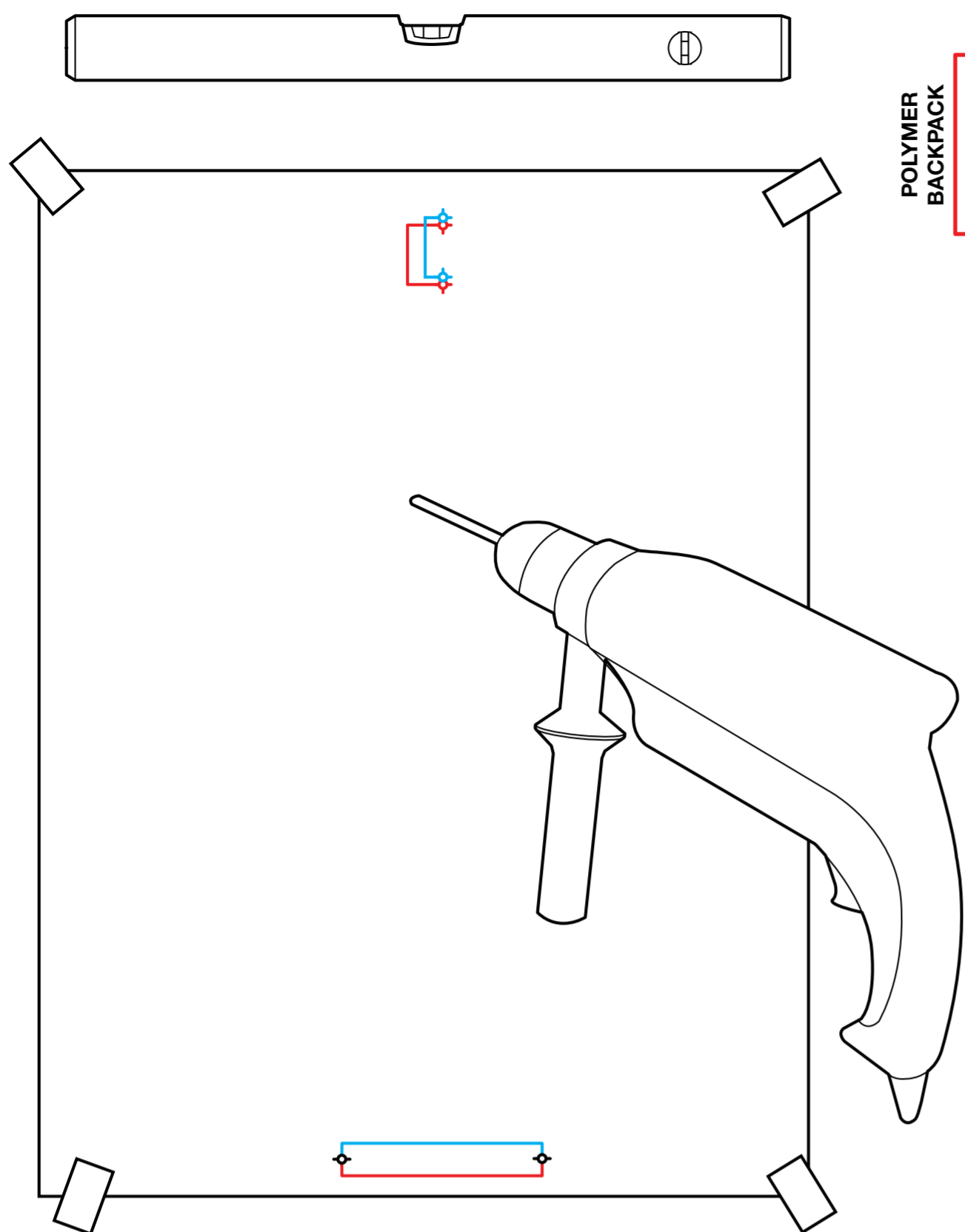

TOP SECTION DRILL SIZE

FOR STONE / CONCRETE / DRYWALL SURFACES OR FOR WOODEN SURFACES

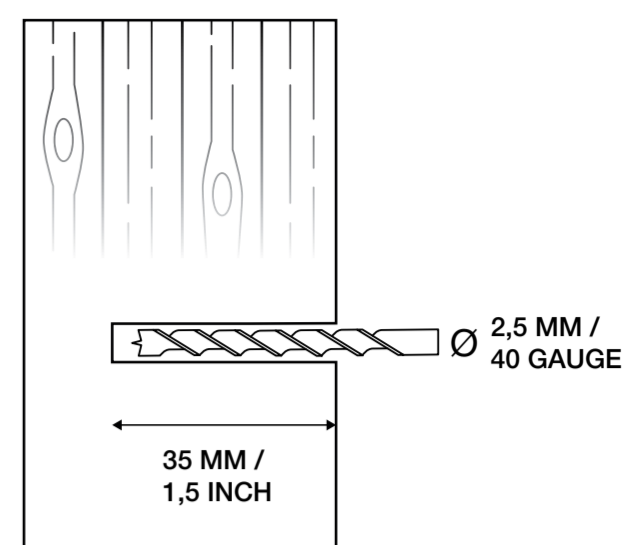
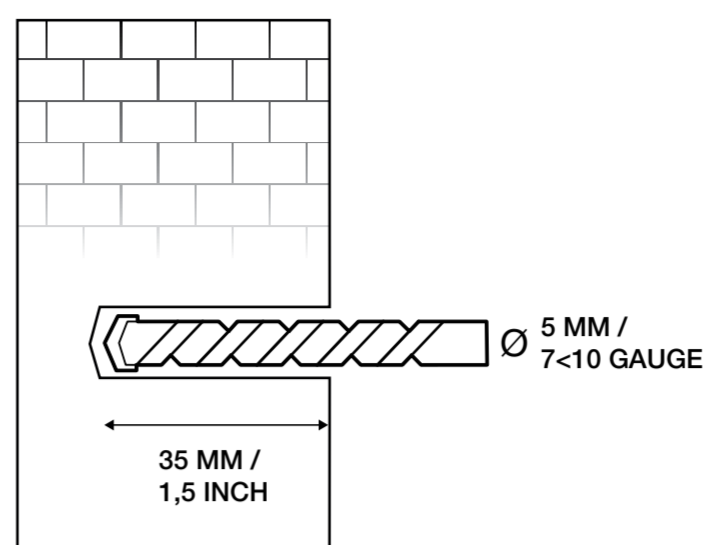

! TOP AND BOTTOM SECTIONS REQUIRE DIFFERENT HOLE SIZES

BOTTOM SECTION DRILL SIZE

FOR STONE / CONCRETE / DRYWALL SURFACES OR FOR WOODEN SURFACES

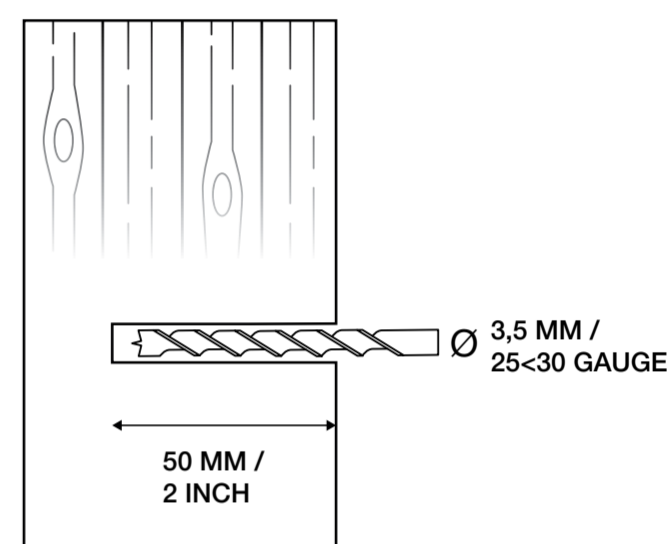
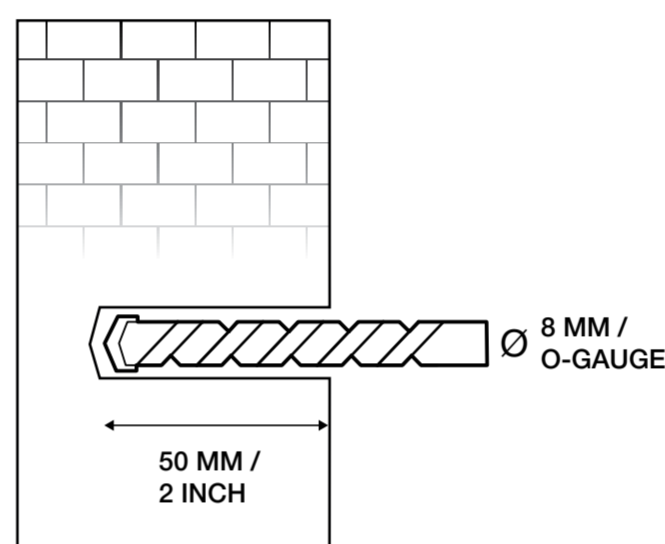

POSITIONING

PLACEMENT

USING THE RIGHT PARTS

FOR STONE / CONCRETE / DRYWALL SURFACES, OR FOR WOODEN SURFACES

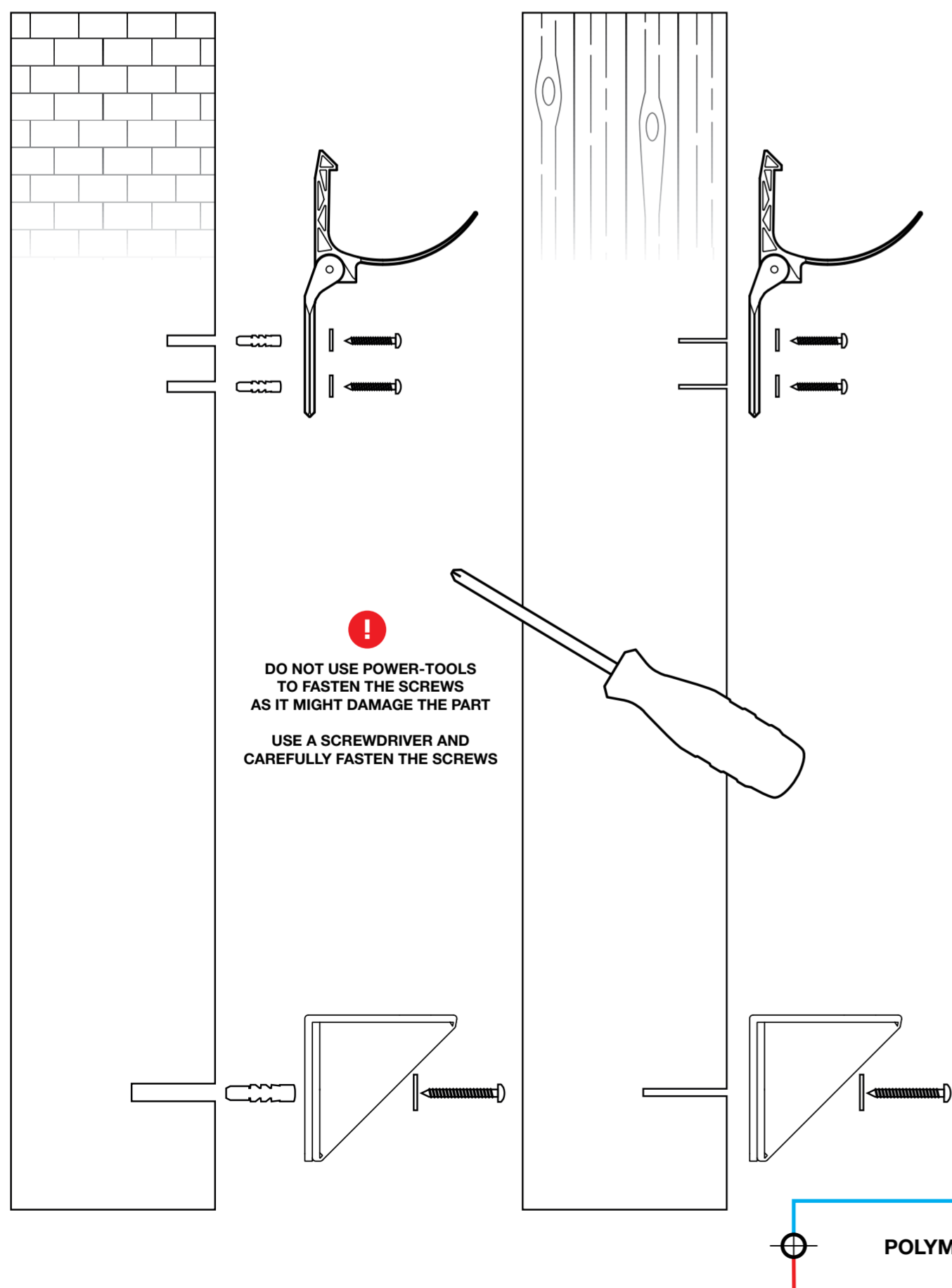

PLACEMENT

TOP SECTION ADJUSTMENT

SLIGHTLY LOOSEN THE SCREWS, ADJUST THE HEIGHT, THEN TIGHTEN THE SCREWS AGAIN

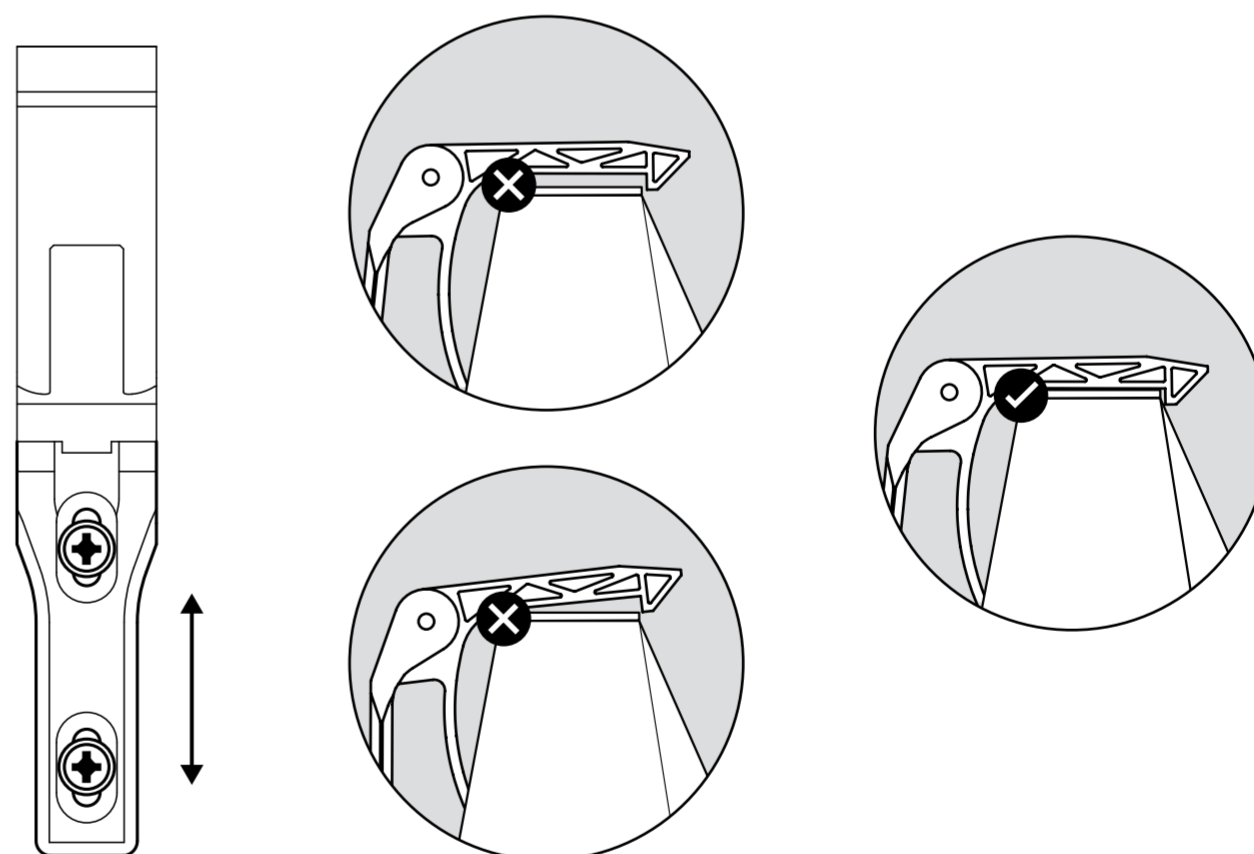

BOTTOM SECTION ADJUSTMENT

SLIGHTLY LOOSEN THE SCREWS, LEVEL THE BOTTOM PART, THEN TIGHTEN THE SCREWS AGAIN

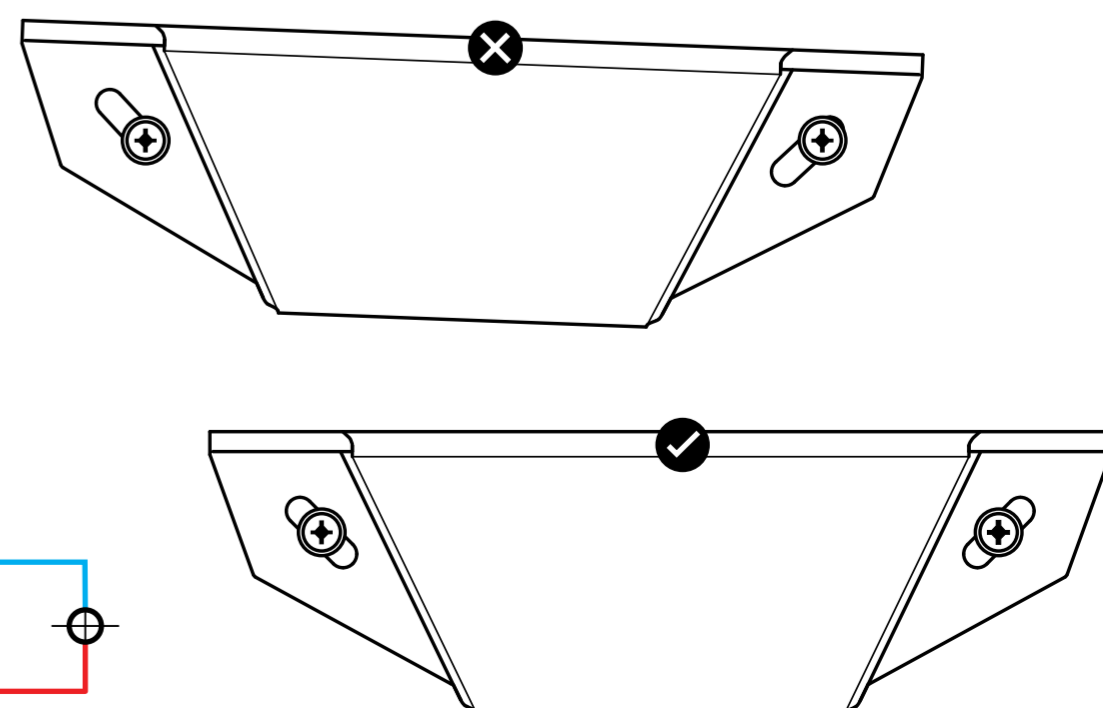

ADJUSTMENTS